

Facts & Figures

Event Planner

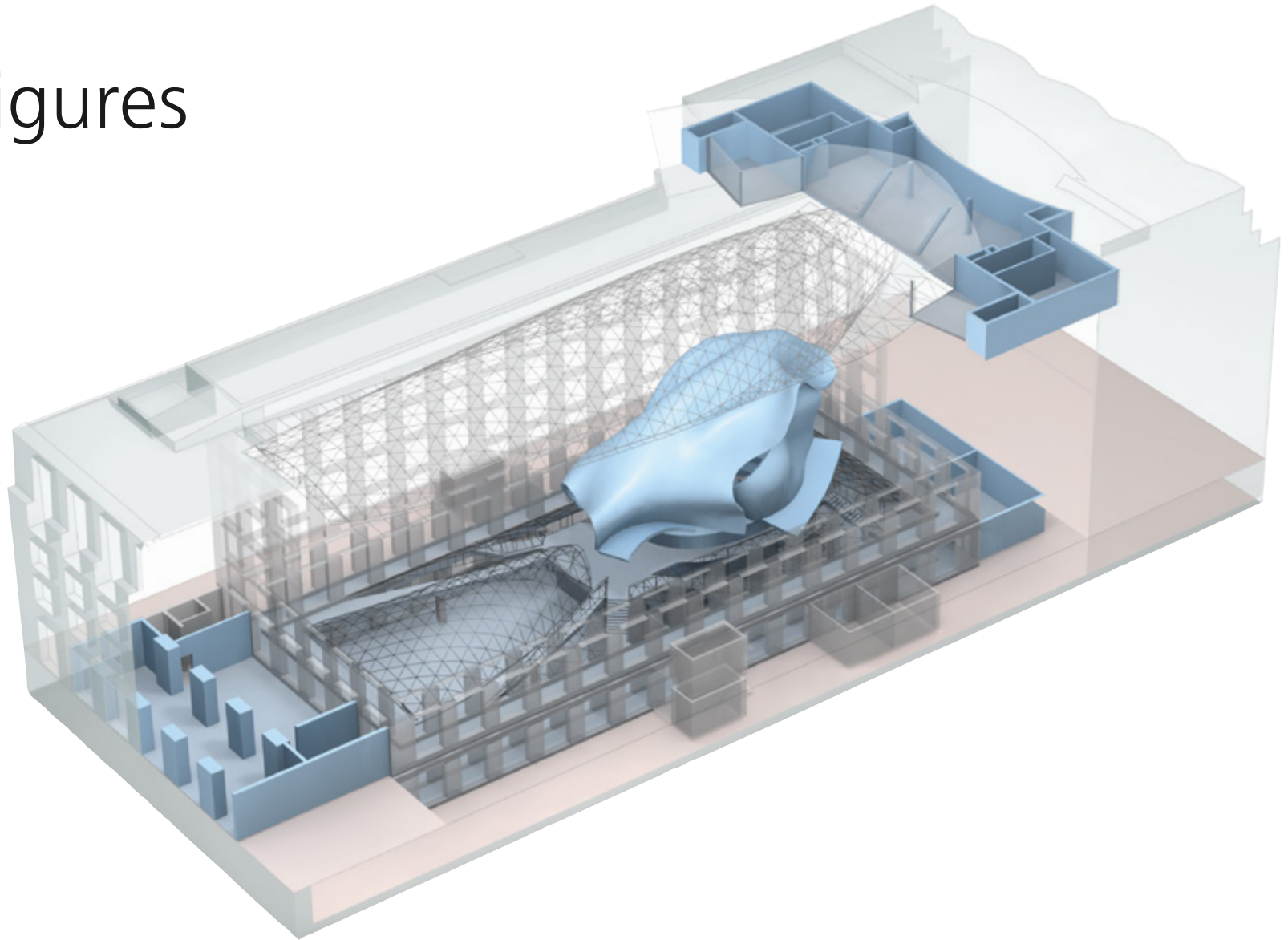

Here you will find all the details necessary for planning your event: floor plans, technical data and information on room design, capacities and services available at AXICA.

Ground Floor

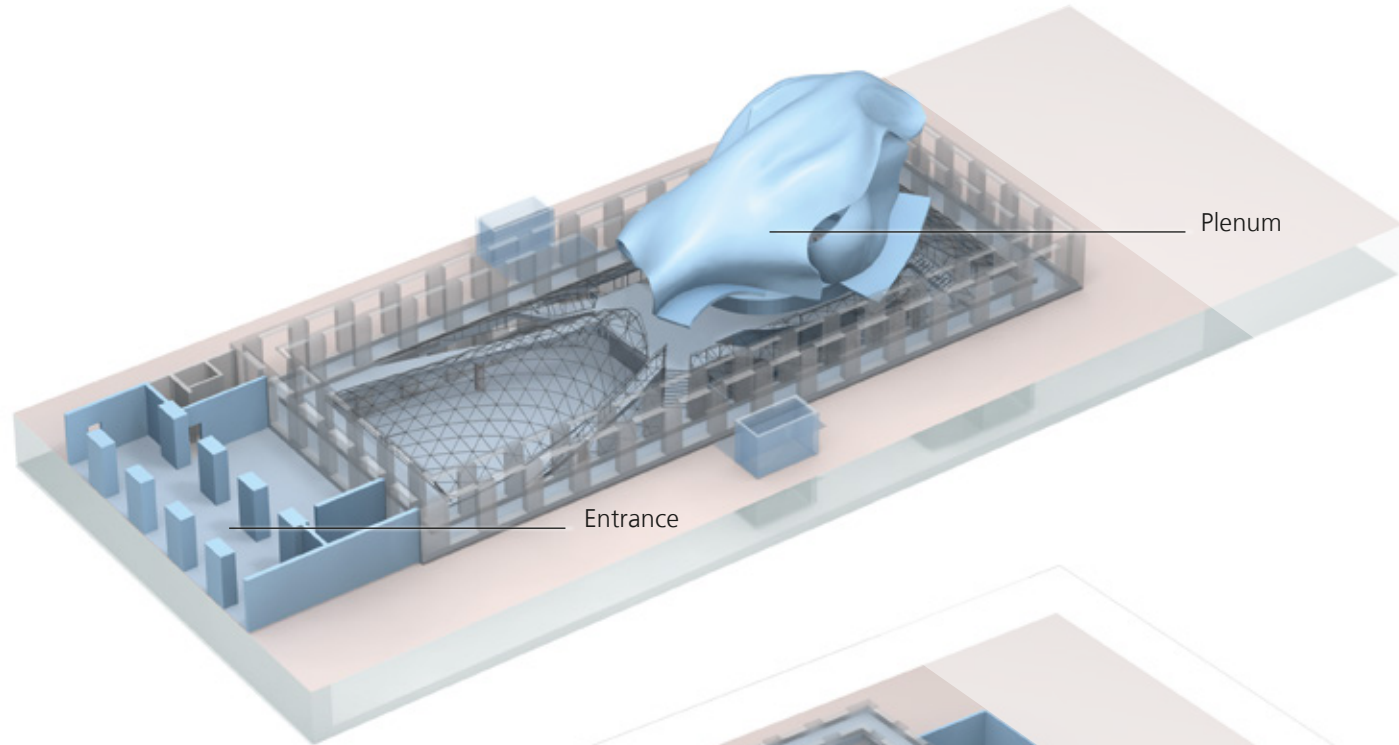



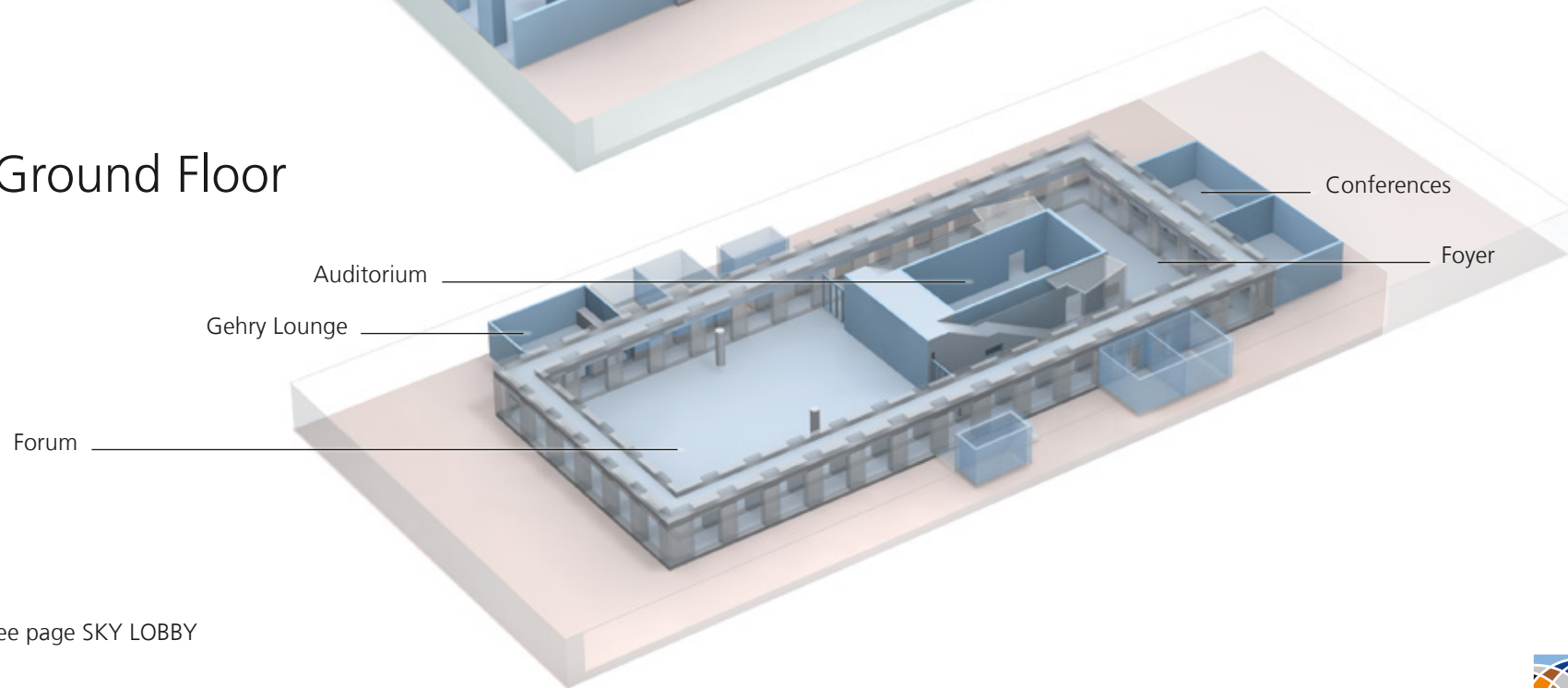

Lower Ground Floor

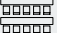

TOP FLOOR » see page SKY LOBBY

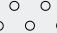
Capacities Overview

SPACES	AREA	CLASSROOM 	THEATRE 	BANQUET 	RECEPTION 	BOARDROOM 
PLENUM	188 m ²	74 delegates	80 delegates	-	-	20 delegates
FORUM	530 m ²	250 delegates	500 delegates	350 delegates	500 delegates	-
FOYER	200 m ²	-	84 delegates	80 delegates	250 delegates	-
AUDITORIUM 1 & 2*	107 m ²	60 delegates	100 delegates	-	-	30 delegates
CONFERENCES 1 & 2*	68 m ²	30 delegates	55 delegates	-	-	25 delegates
CONFERENCES 3 & 4*	55 m ²	24 delegates	40 delegates	-	-	20 delegates
CONFERENCES 5 & 6*	86 m ²	28 delegates	70 delegates	-	-	30 delegates
GEHRY LOUNGE	70 m ²	-	-	35 delegates	35 delegates**	-
SKY LOBBY	204 m ²	40 delegates	80 delegates	50 delegates	80 delegates	-
SKY LOUNGES	46 m ²	-	25 delegates	12 delegates	20 delegates	18 delegates
QUADRIGA	65 m ²	-	45 delegates	-	40 delegates	26 delegates

* flexible partitioning ** café seating

Interior & Furnishing

- » fully air-conditioned rooms
- » double glass roof allows natural lighting on all floors
- » colour: red carpet, parquet flooring in arcades and Plenum, pine wall panels
- » white lighting, partly dimmable
- » designer furniture
- » fitted bar in the Gehry Lounge
- » Facilities accessible for people with disabilities
- » green electricity

Technology & Equipment

- » access to WLAN
- » power points
- » technical cooperation with event production experts
- » goods lift (1.40 x 2.50 x 2.40 m high), capacity 27 (maximum load 2,500 kg), space between opened doors 1.39 m
- » separate delivery area (4.50 m wide x 3.00 m high), maximum load 3,500 kg

Services

- » in-house catering and service team
- » cooperation for decoration and furniture
- » in-house security team
- » hostesses (cloakroom service and admission)
- » entertainment
- » guest management

We are happy to supply other services on request.

Notes

Adress

AXICA
Kongress-und Tagungszentrum GmbH
Pariser Platz 3 / D-10117 Berlin
Fon +49 30 200086-0

info@axica.de
www.axica.de

Delivery area / Delivery address

AXICA
Behrenstrasse 73 / D-10117 Berlin



Ground Floor

M 1:400

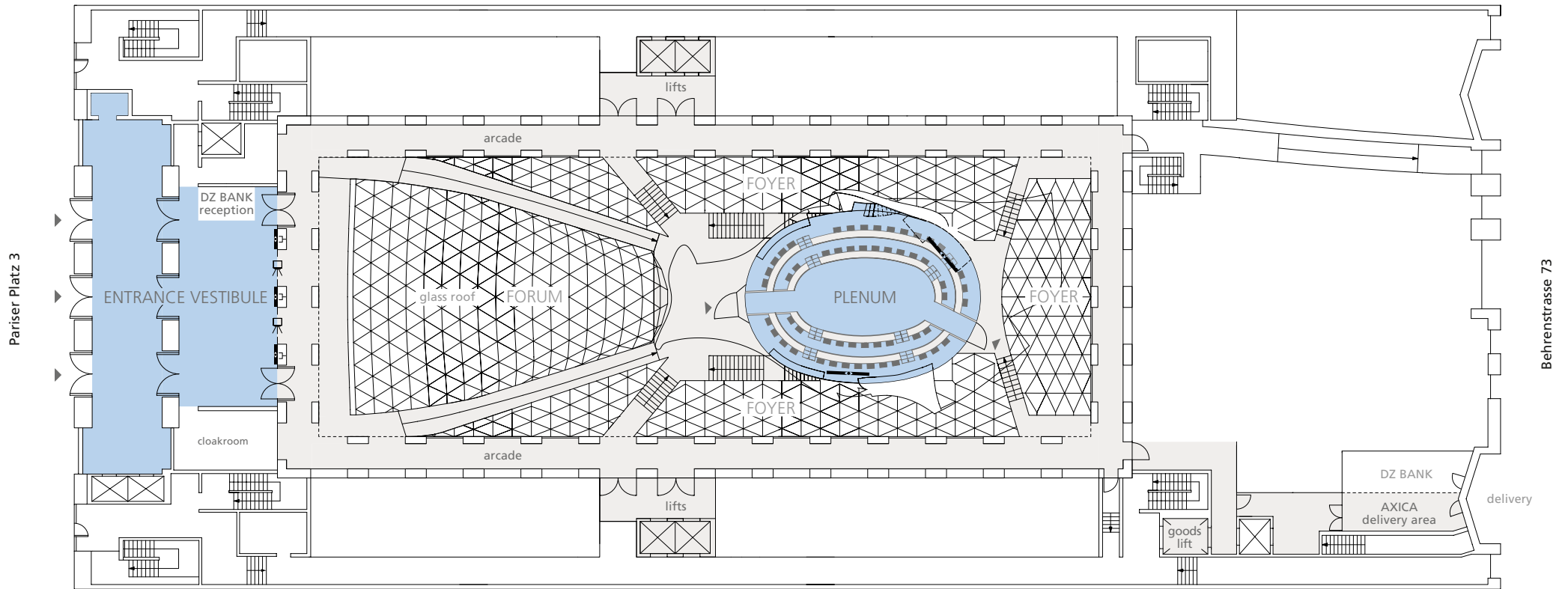



Lower Ground Floor

M 1:400



Pariser Platz 3

Behrenstrasse 73

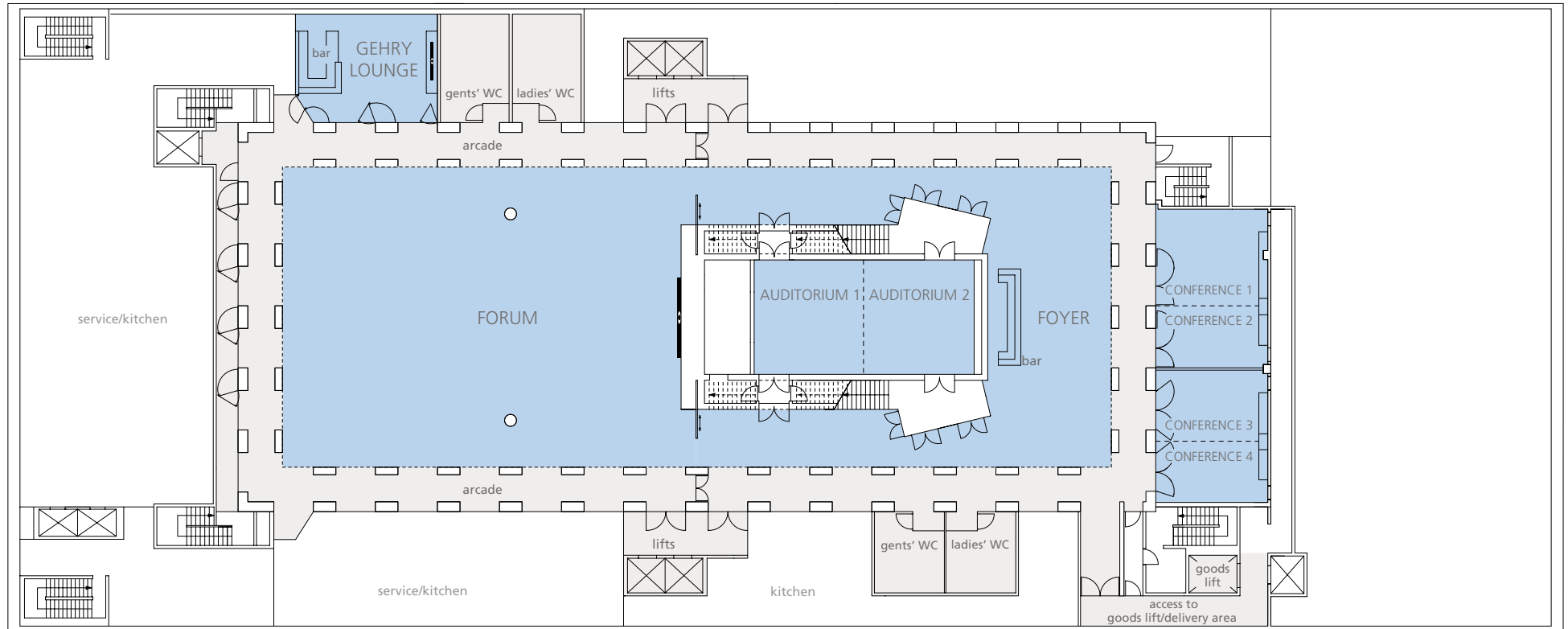

The Entrance Vestibule

Ground Floor

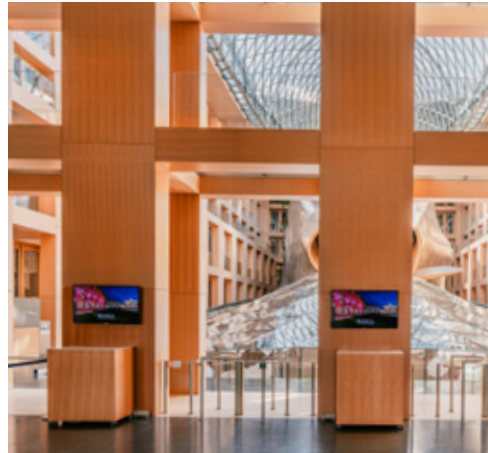

Event type

- » accreditation
- » cloakroom

Interior & Furnishing

- » Italian limestone façade
- » large steel glass doors
- » granite floor
- » access to Wi-Fi

Equipment & Service

- » 3 LCD screens 47"
- » signage system
- » hostess and cloakroom service
- » in-house security
- » Wi-Fi

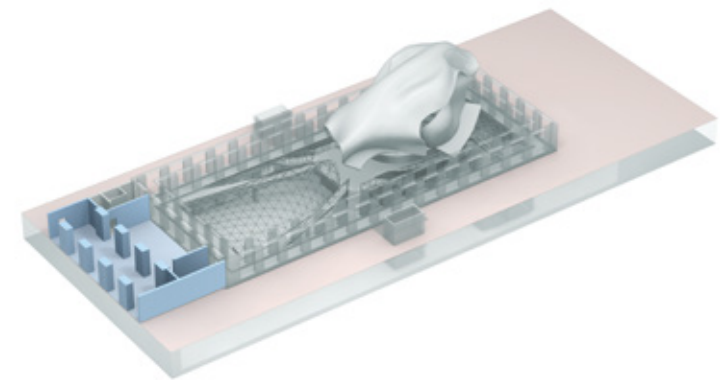



The Entrance Vestibule Ground Floor

M 1:200

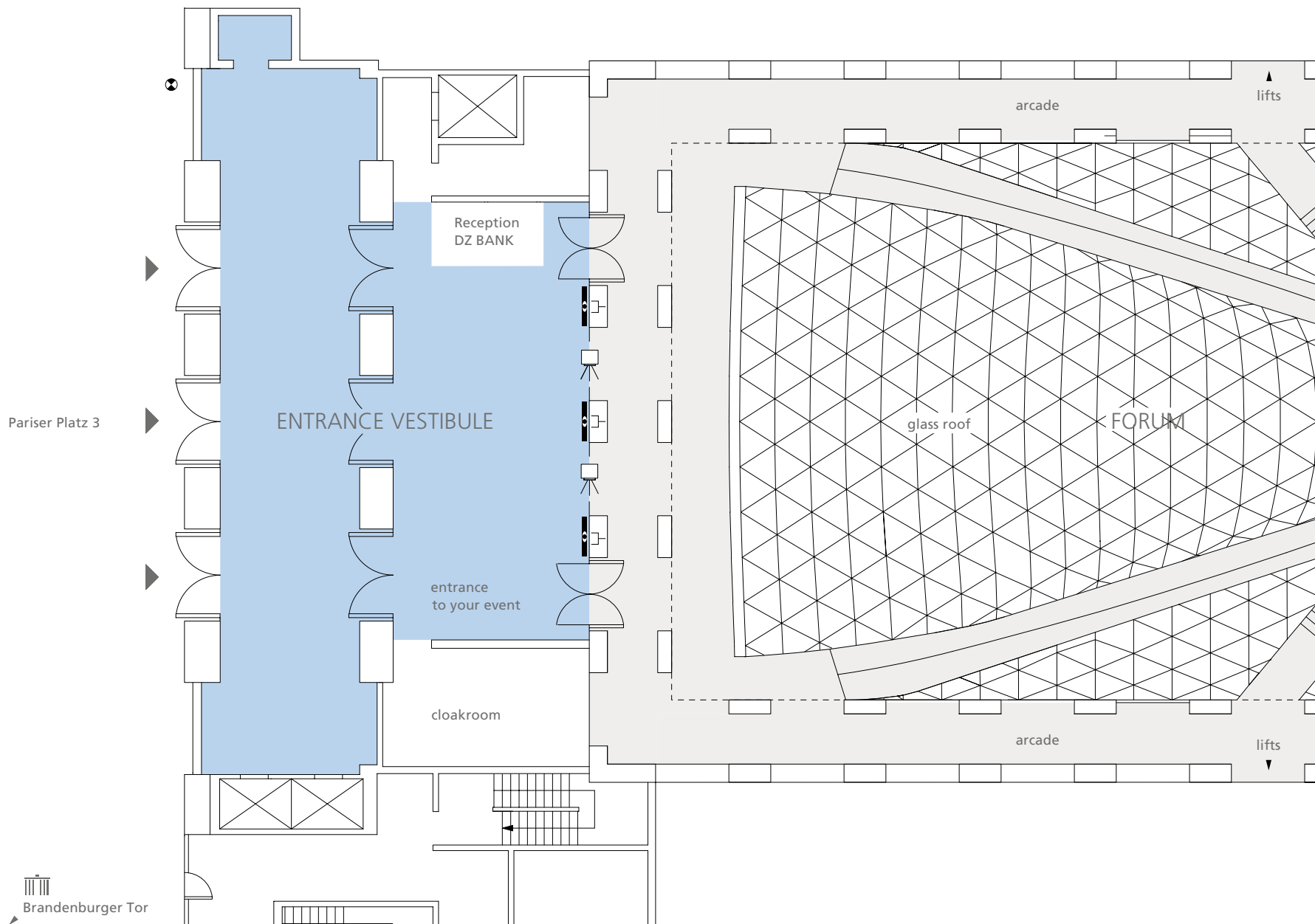

- TV and audio broadcasting system and floor cabling with data lines
- power point
- LCD screen 47"

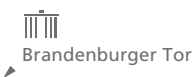

The Plenum

Ground Floor



Event type

- » press conferences
- » workshops
- » meetings
- » lectures
- » plenary sessions
- » product presentations
- » podium discussions

Interior & Furnishing

- » flexible seating within the rows
- » variable speaker positioning
- » flexible seating on the parquet
- » boardroom table
- » sound-proofed wall panels
- » direct daylight

Technology & Equipment

- » sound system with podium miking
- » Digital desktop intercom stations with voting function
- » digital audio / 2-channel graphic controls inclusive external sources
- » 2 displays 110" & 136"
- » portable 40" preview monitors
- » extensive infrastructure (optical fibre, network and high power)
- » dedicated 100Mbit/s network cable connected
- » technical cooperation with event production experts

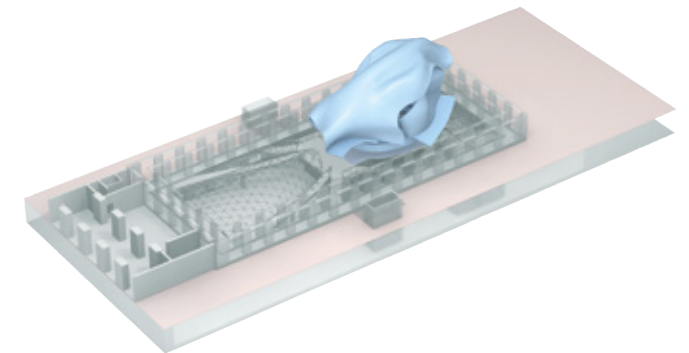



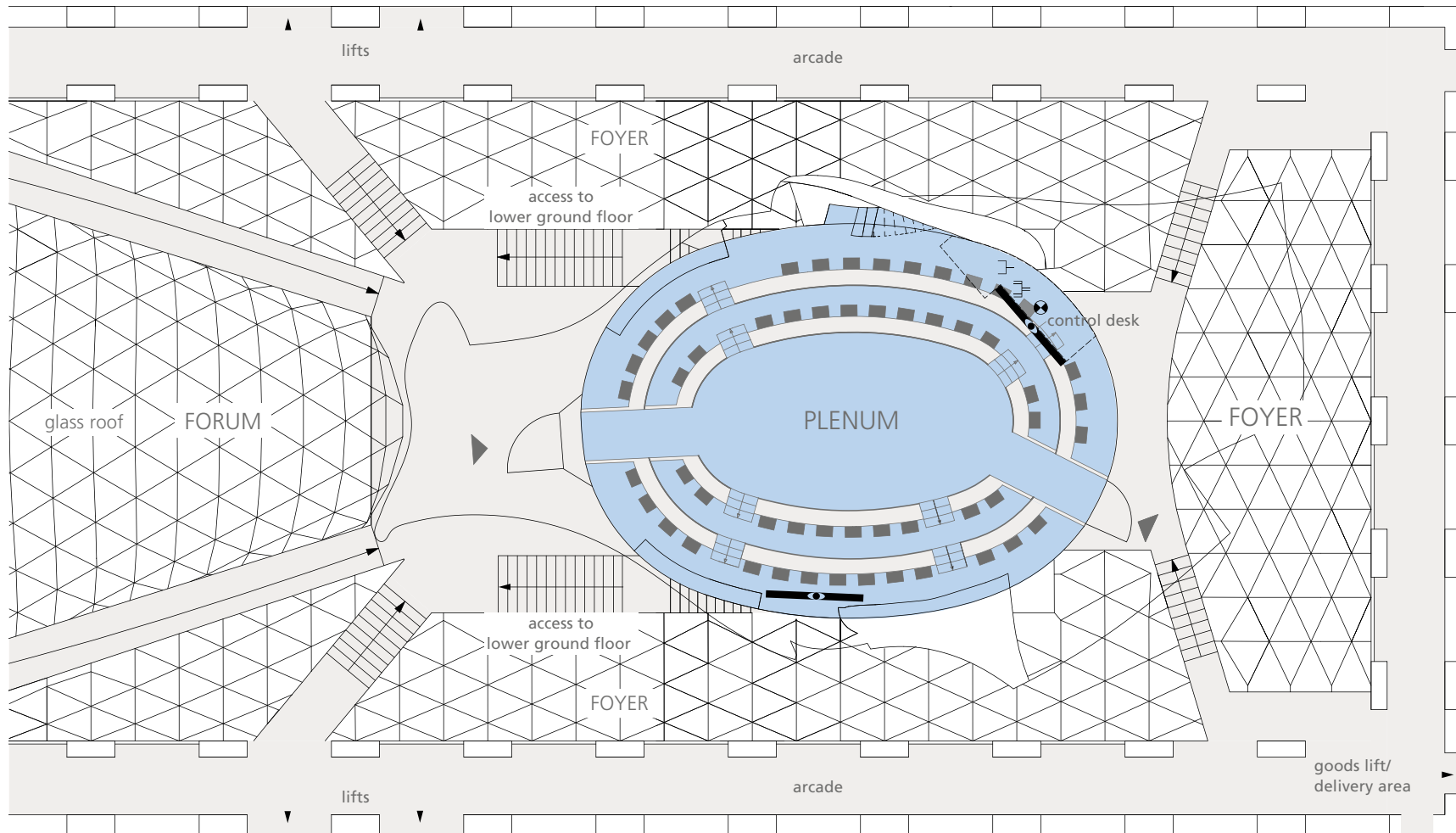

The Plenum Ground Floor

M 1:200

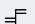
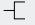

-  access channels to tv and audio transmission
-  3-phase power point
-  power point
-  LCD screen 110" & 136"

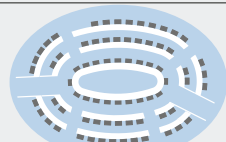
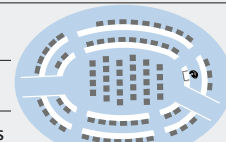
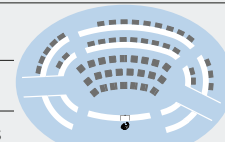
DIMENSIONS	SEATING CAPACITY BOARDROOM	THEATRE	PODIUM
Area 188 m ²	 <ul style="list-style-type: none"> maximum 74 delegates parquet 20 delegates seating rows 54 delegates 	 <ul style="list-style-type: none"> maximum 80 delegates parquet 28 delegates seating rows 52 delegates 	 <ul style="list-style-type: none"> maximum 54 delegates parquet 24 delegates seating rows 30 delegates

The Forum

Lower Ground Floor



Event type

- » receptions
- » gala dinners
- » congresses
- » symposia
- » conferences
- » meetings
- » presentations
- » exhibitions
- » fashion shows
- » concerts

Interior & Furnishing

- » direct daylight, glass roof
- » red carpet
- » glass art installation
- » smooth-faced concrete wall (12 m wide and 5.58 m high)
- » access to Foyer and Gehry Lounge
- » designer furniture

Technology & Equipment

- » dimmable lighting
- » TV frequency links
- » access to Wi-Fi
- » power points
- » technical cooperation with event production experts
- » LED media wall (W 6,10 x H 2,74 m)
- » invisible cable duct integrated in the floor

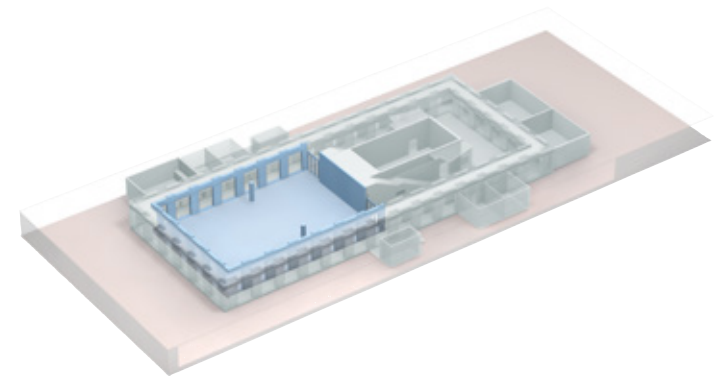





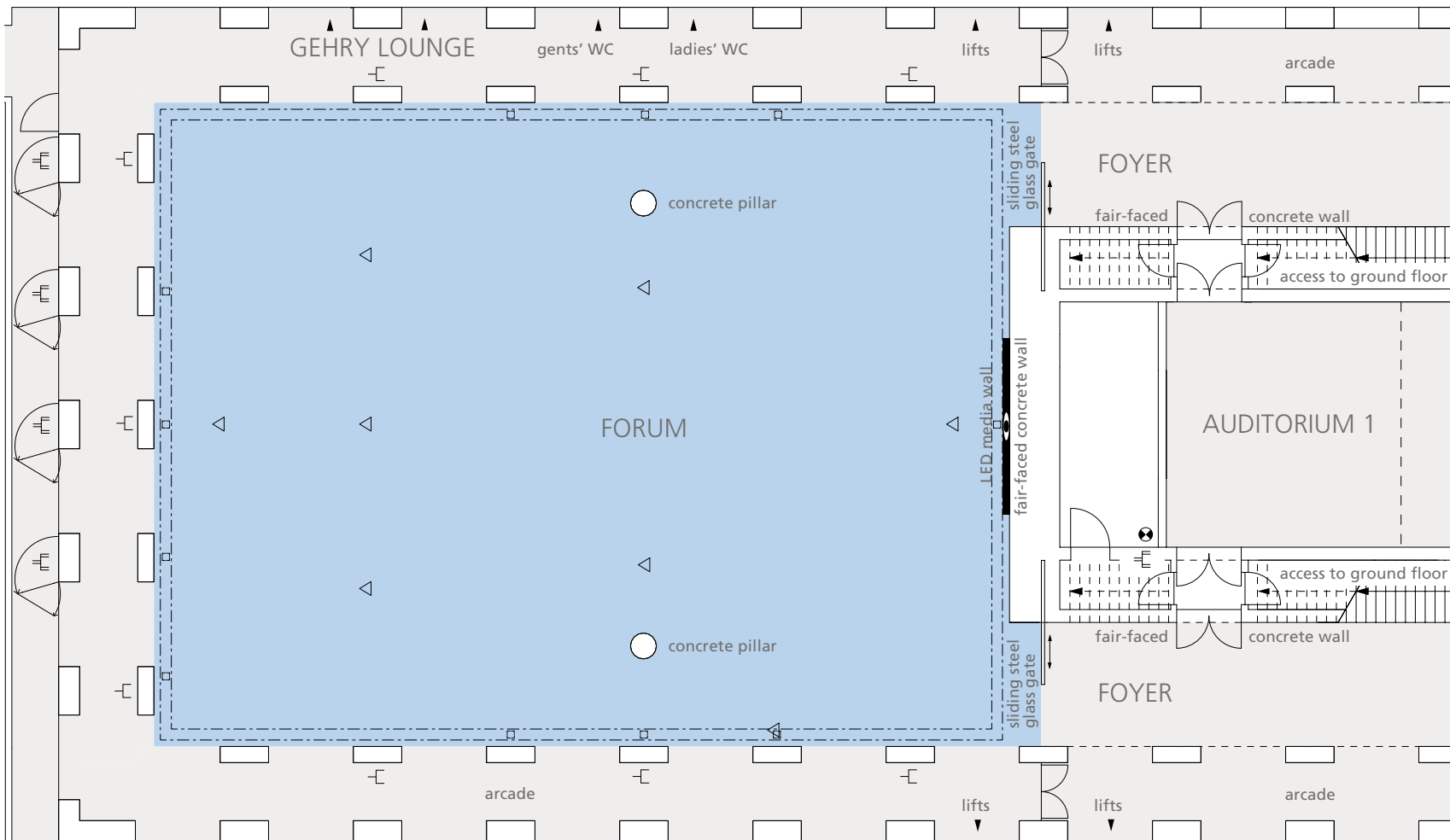

The Forum Lower Ground Floor

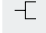
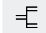
M 1:200

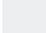
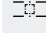

-  power point
-  3-phase power point
-  power, tel./data lines
-  access ways TV and audio broadcasting system
-  cable duct with port
-  LED media wall
W 6,10 x H 2,74 m

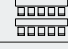
DIMENSIONS	
total area	530 m ²
length	26,50 m
width	20,00 m
height	3,32 m – 5,58 m

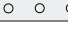
SEATING CAPACITY		including podium (8 x 4 m)	
classroom		250 delegates	250 delegates
theatre		500 delegates	500 delegates
banquet		350 delegates	320 delegates
reception		500 delegates	500 delegates

The Foyer

Lower Ground Floor



Event type

- » receptions
- » coffee breaks
- » exhibitions & product presentations
- » cocktail bar & lounge
- » dinner & meetings

Interior & Furnishing

- » direct daylight
- » red carpet
- » arcade
- » access to all spaces
- » Wi-Fi

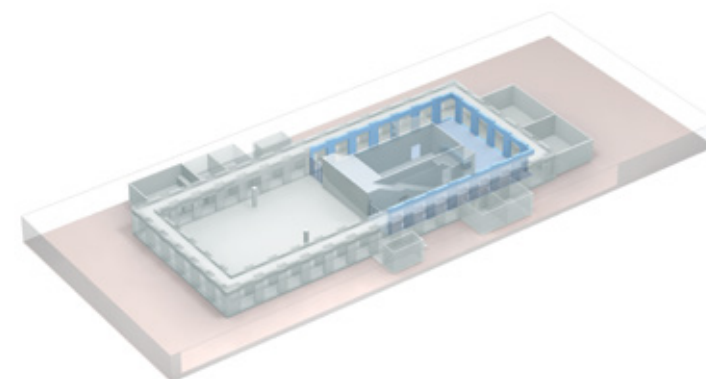





The Foyer Lower Ground Floor

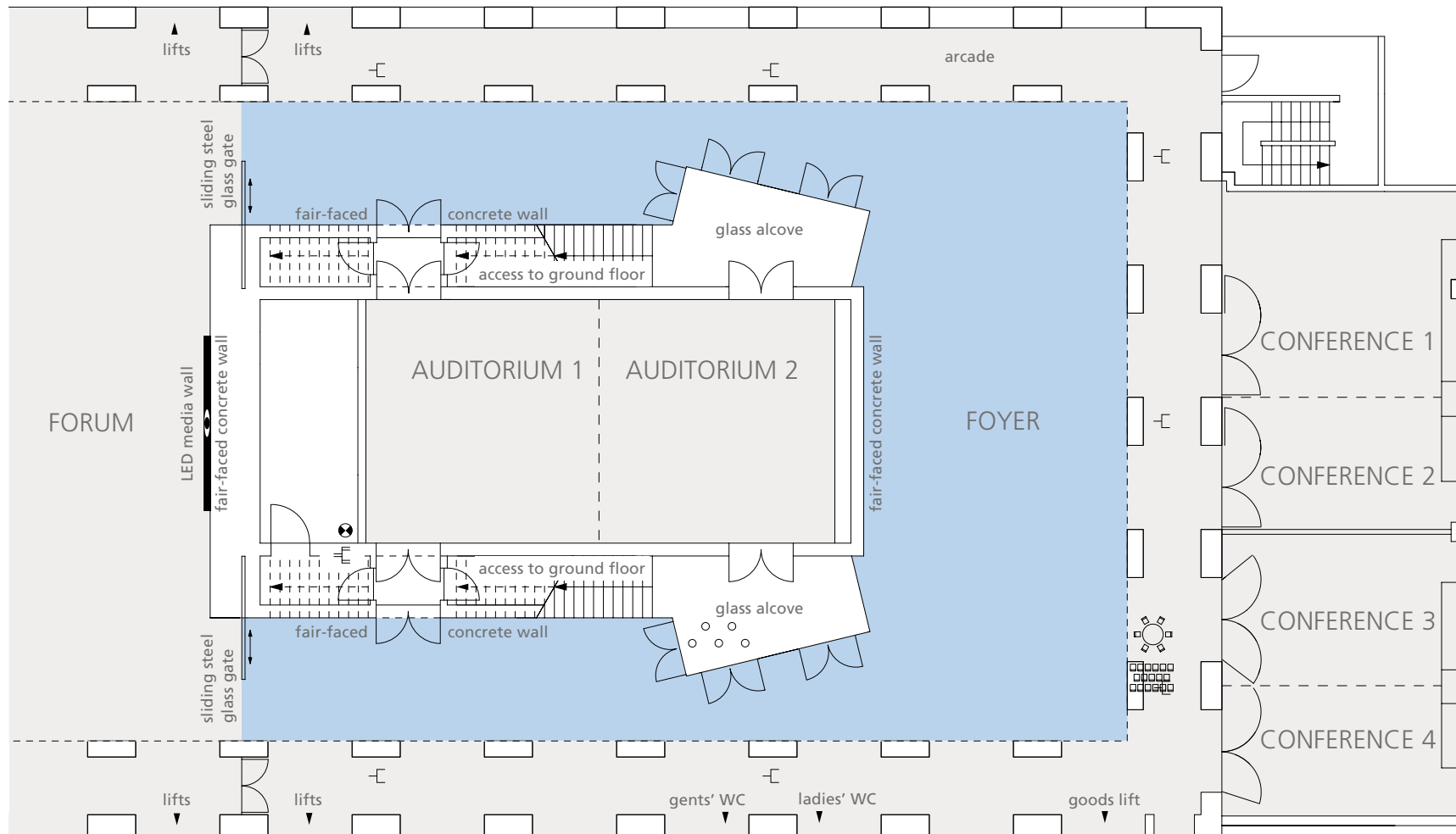

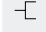
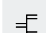
M 1:200

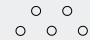

-  power point
-  3-phase power point
-  access ways TV and audio broadcasting system

DIMENSIONS	
total area	200 m ²

SEATING CAPACITY	
reception/buffet	 250 delegates
exhibition	depends on exhibition size

banquet	 80 delegates
theater	 84 delegates

The Auditorium

Lower Ground Floor



Event type

- » workshops
- » meetings
- » exhibitions & product presentations
- » additional service area
- » press conferences
- » lectures

Interior & Furnishing

- » flexible room concept; can be divided into two separate areas
- » indirect lighting
- » under-floor air-conditioning
- » red carpet

Technology & Equipment

- » Wi-Fi
- » technical cooperation with event production experts

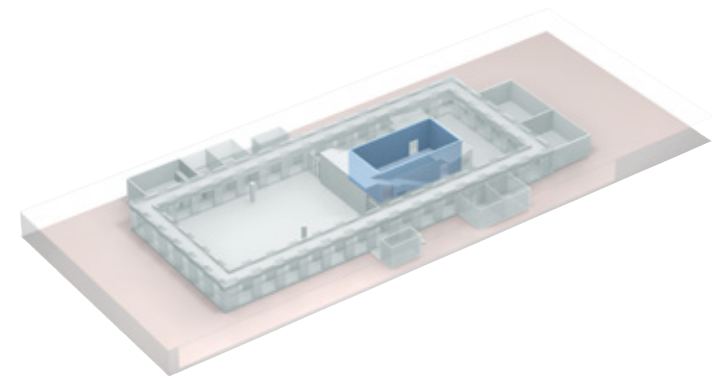







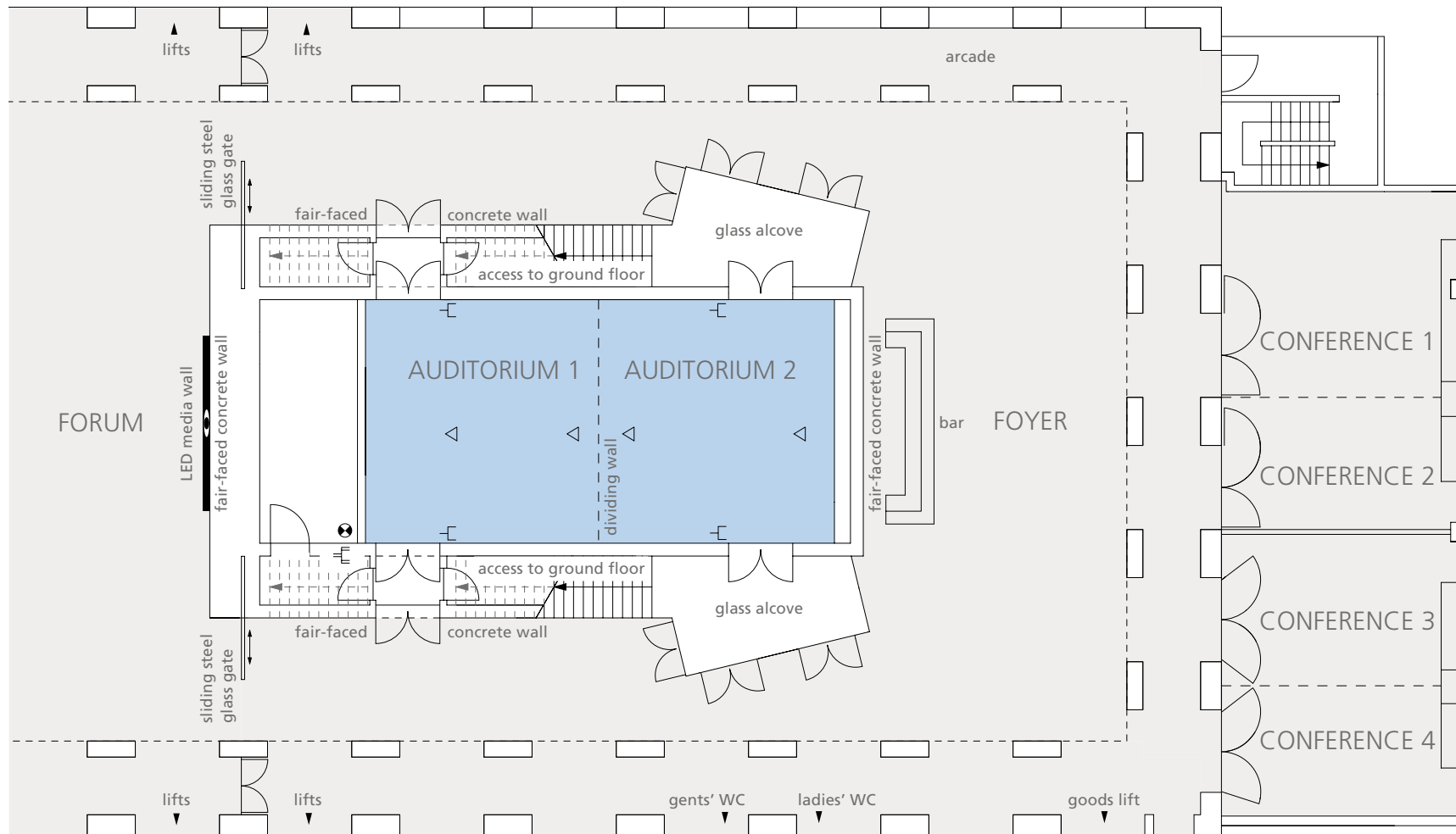

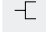
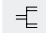
The Auditorium Lower Ground Floor

M 1:200



-  power point
-  3-phase power point
-  power, tel./data lines
-  access ways TV and audio broadcasting system

DIMENSIONS	Auditorium 1 & 2	Auditorium 1	Auditorium 2
total area	107,38 m ²	53,36 m ²	53,28 m ²
length	14,55 m	7,22 m	7,20 m
width	7,38 m	7,38 m	7,38 m
height	4,55 m	4,55 m	4,55 m

		Auditorium 1 & 2	Auditorium 1	Auditorium 2
SEATING CAPACITY				
classroom		60 delegates	20 delegates	20 delegates
boardroom		30 delegates	16 delegates	16 delegates
theatre		100 delegates	35 delegates	35 delegates
U-shape		30 delegates	12 delegates	12 delegates

The Conferences

Lower Ground Floor



Event type

- » conferences
- » workshops
- » presentations
- » lounge
- » exhibitions
- » additional service area

Interior & Furnishing

- » indirect daylight
- » flexible room concept;
partition walls
- » red carpet

Technology & Equipment

- » Wi-Fi
- » floor cabled with power points
- » TV frequency links

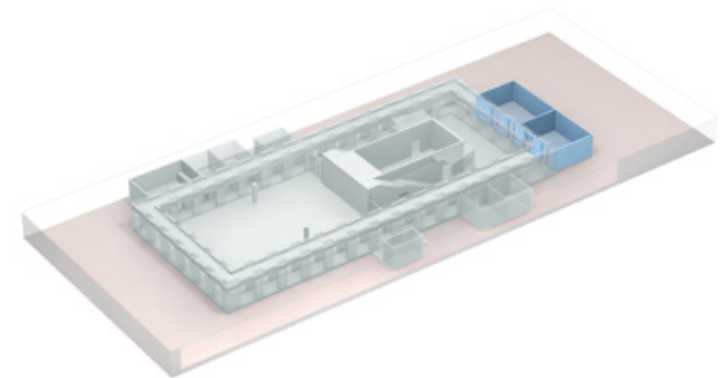



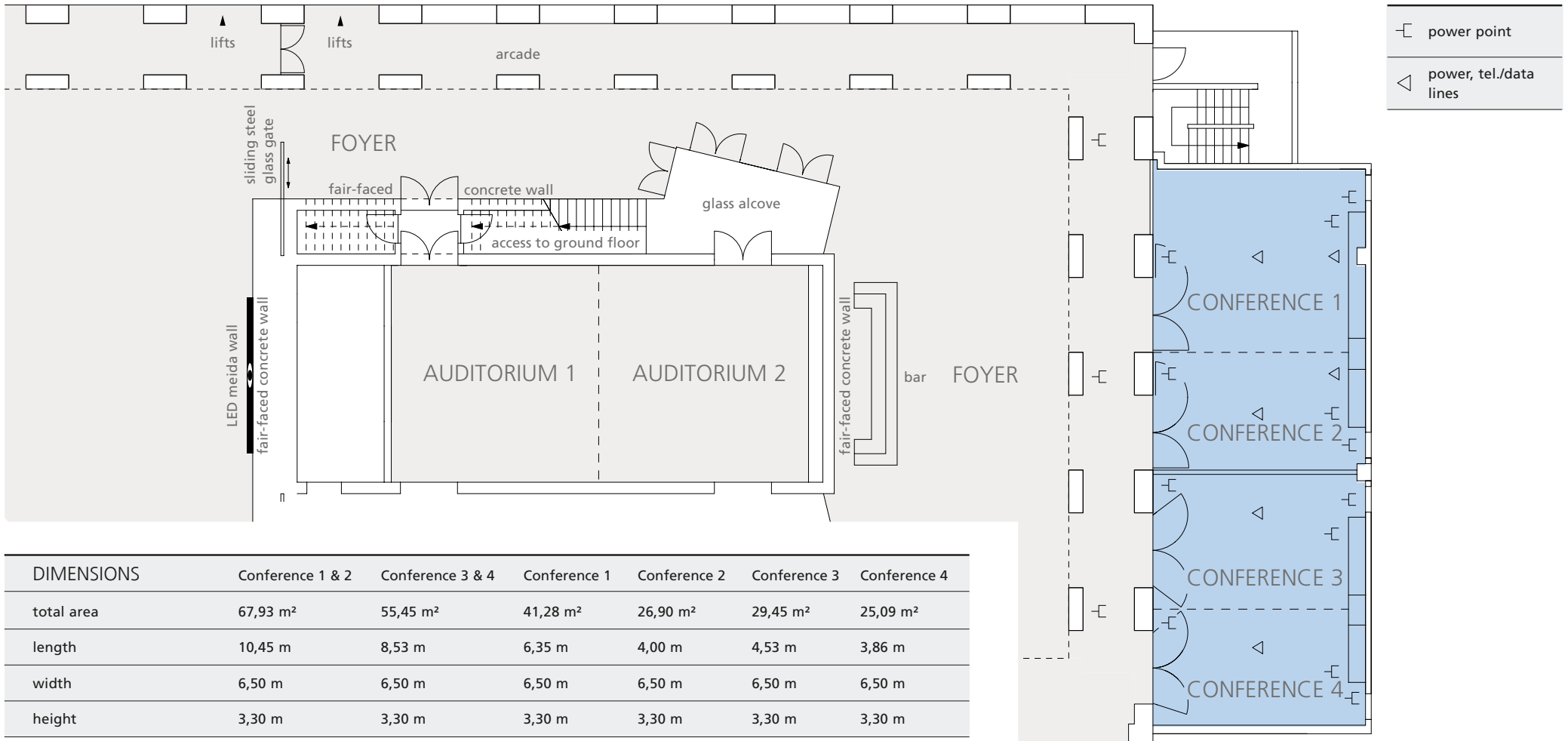

The Conferences Lower Ground Floor

M 1:200



DIMENSIONS	Conference 1 & 2	Conference 3 & 4	Conference 1	Conference 2	Conference 3	Conference 4
total area	67,93 m ²	55,45 m ²	41,28 m ²	26,90 m ²	29,45 m ²	25,09 m ²
length	10,45 m	8,53 m	6,35 m	4,00 m	4,53 m	3,86 m
width	6,50 m	6,50 m	6,50 m	6,50 m	6,50 m	6,50 m
height	3,30 m	3,30 m	3,30 m	3,30 m	3,30 m	3,30 m

SEATING CAPACITY	Conference 1 & 2	Conference 3 & 4	Conference 1	Conference 2	Conference 3	Conference 4
classroom 	30 delegates	24 delegates	-	-	-	-
boardroom 	25 delegates	20 delegates	12 delegates	10 delegates	10 delegates	10 delegates
theatre 	55 delegates	40 delegates	-	-	-	-

The Gehry Lounge

Lower Ground Floor



Event type

- » cocktail bar & lounge
- » receptions
- » coffee breaks
- » VIP lounge

Interior & Furnishing

- » wooden seating designed by Frank O. Gehry
- » fitted coffee and cocktail bar
- » parquet floor
- » LED screen 58"
- » Wi-Fi

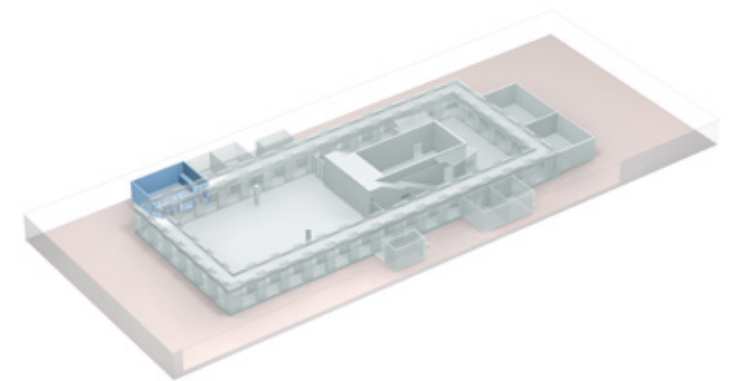





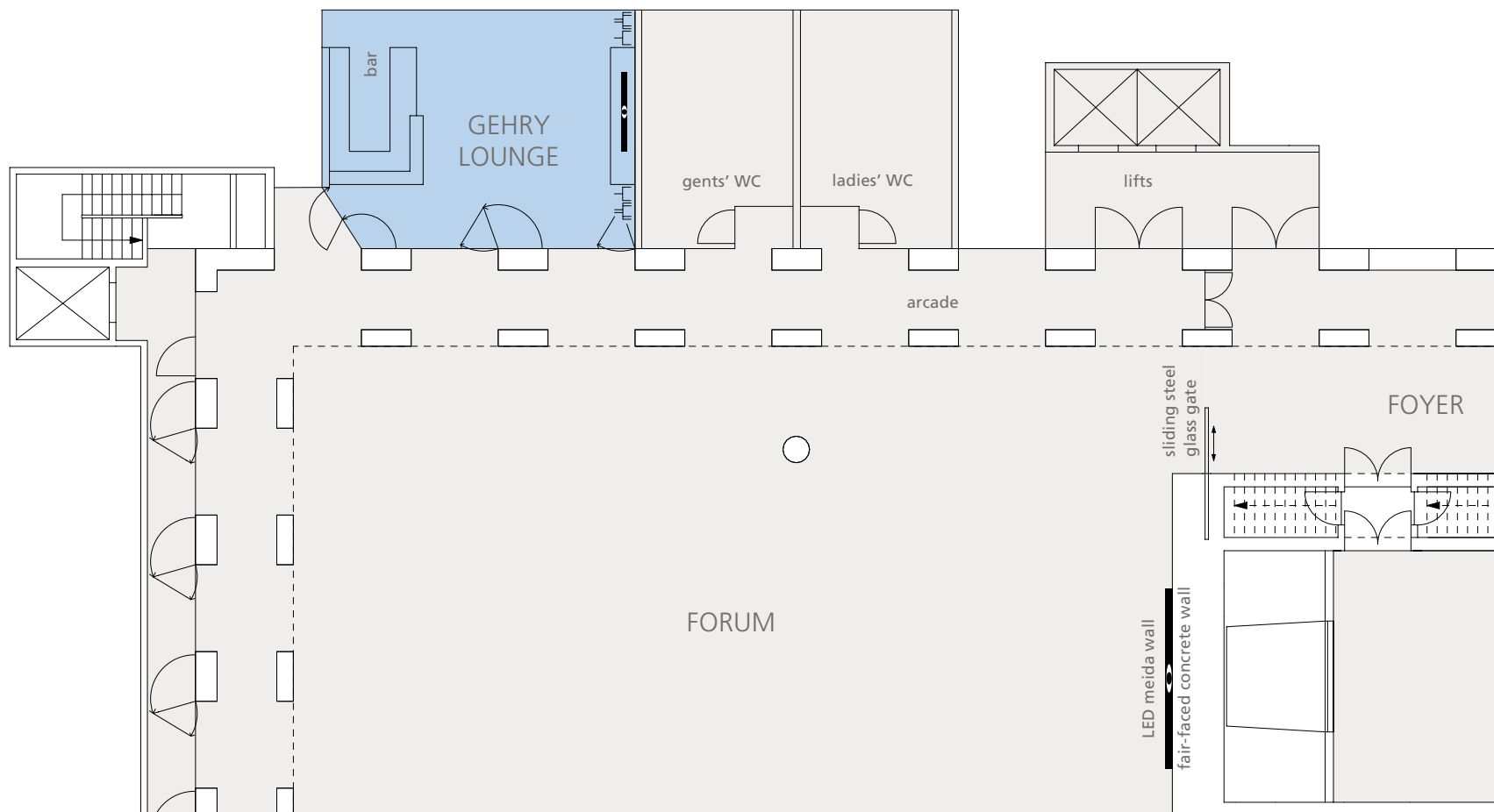

The Gehry Lounge Lower Ground Floor

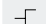
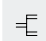
M 1:200



-  power point
-  3-phase power point
-  LED screen 58"

DIMENSIONS	
total area	70 m ²
length	9,20 m
width	7,10 m
height	4,50 m

SEATING CAPACITY		
café seating		35 delegates
reception		35 delegates

The Gallery

with Boardroom and Quadriga room

First Floor



The Gallery

Event Type

- » receptions

Interior & Furnishing

- » direct daylight
- » view to the Brandenburg Gate

Equipment & Service

- » 220V power connections
- » Wi-Fi
- » technical cooperation with event production experts

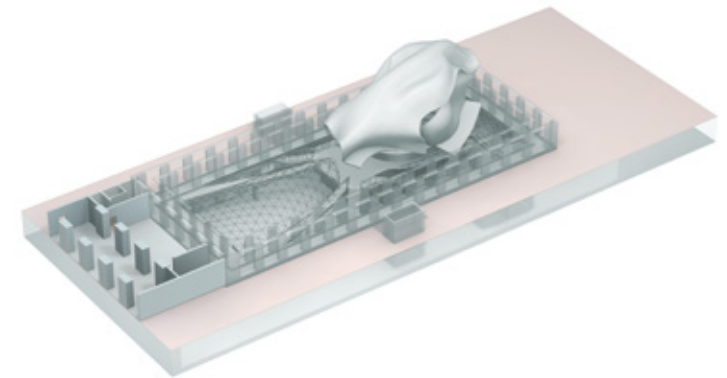

Boardroom and Quadriga room

Event Type

- » conferences
- » presentations
- » dinner
- » film set

Interior & Furnishing

- » direct daylight
- » view to the Brandenburg Gate
- » fully air-conditioned and ventilated

Equipment & Service

- » 220V power connections
- » Wi-Fi
- » technical cooperation with event production experts

The Gallery with Boardroom and Quadriga room | First Floor

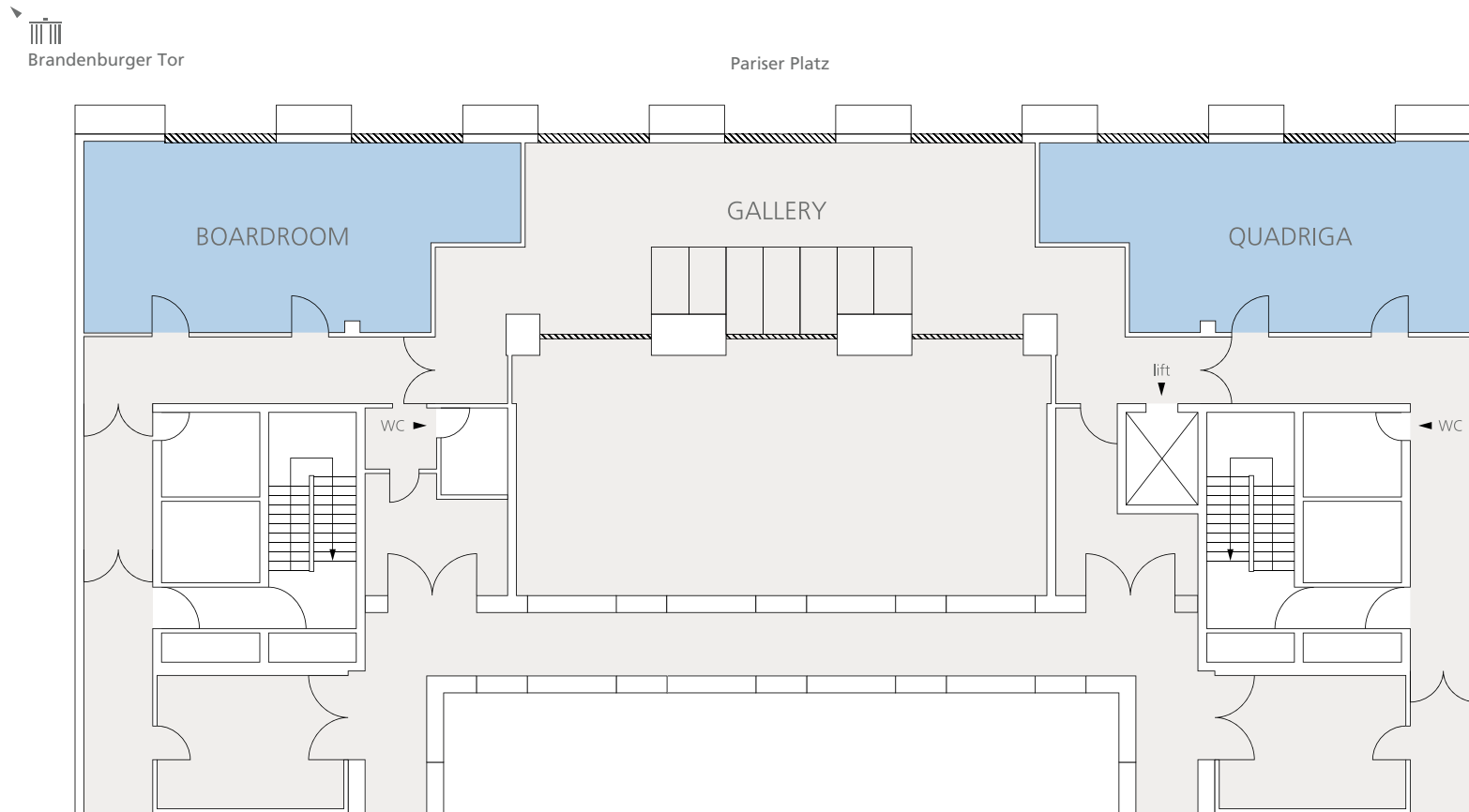

DIMENSIONS	Gallery	Quadriga	Boardroom
total area	75 m ²	65 m ²	65 m ²
length	15 m	12,85 - 10,20 m	12,85 - 10,20 m
width	5 m	5,10 m	5,10 m
height	2,80 m	2,80 m	2,80 m

SEATING CAPACITY	Gallery	Quadriga	Boardroom
boardroom	-	26 delegates	26 delegates
theatre	-	45 delegates	45 delegates
dinner	-	27 delegates	27 delegates
reception	60 delegates	40 delegates	40 delegates

The Conferences 5 & 6

First Floor



Event type

- » workshops
- » presentations
- » conferences
- » Lounge

Interior & Furnishing

- » indirect daylight
- » flexible room concept
- » partition wall
- » carpet

Equipment & Service

- » power connections 220V
- » Wi-Fi
- » technical cooperation with event production experts

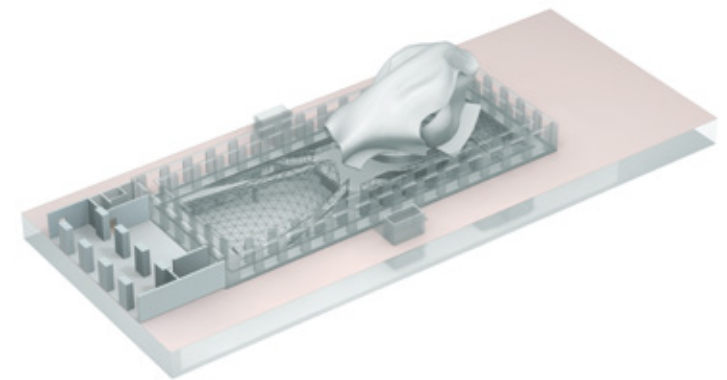



The Conferences 5 & 6 First Floor

M 1:200

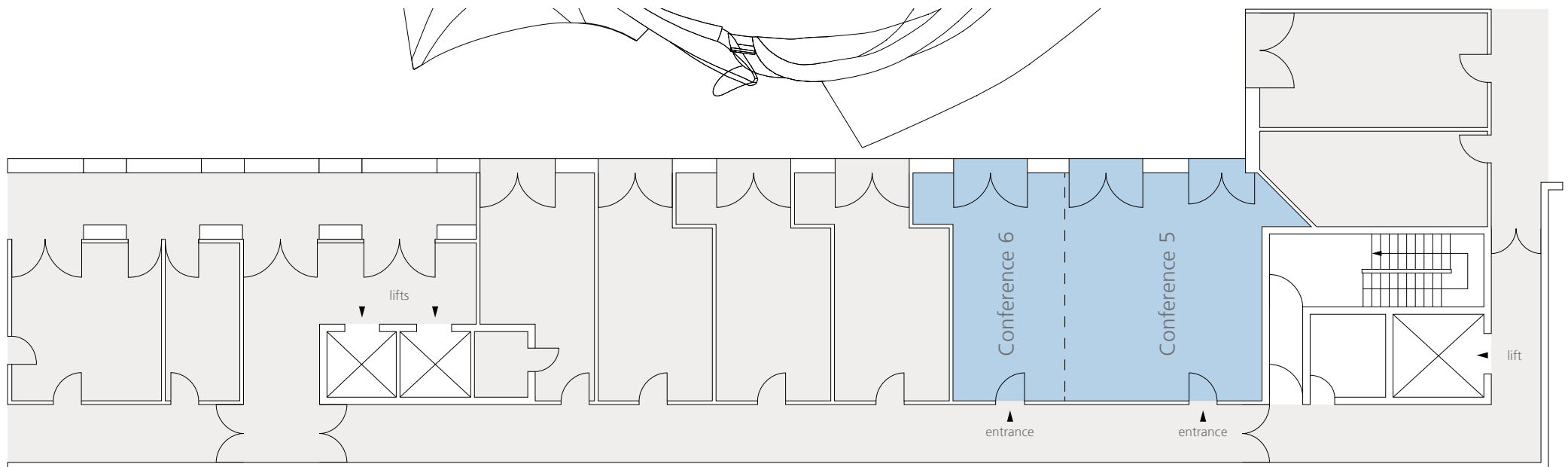

DIMENSIONS	Conference 5	Conference 6	Conference 5 & 6
total area	53 m ²	33 m ²	86 m ²
length	6,75 m	4 m	10,85 m
width	5,50 m	5,50 m	5,50 m
height	2,80 m	2,80 m	2,80 m

SEATING CAPACITY	Conference 5	Conference 6	Conference 5 & 6
boardroom	18 delegates	12 delegates	30 delegates
theatre	35 delegates	20 delegates	70 delegates
U-shape	14-16 delegates	-	24 delegates
classroom	20 delegates	-	28 delegates

The Sky Lobby

With Sky Lounge West & East

Top Floor

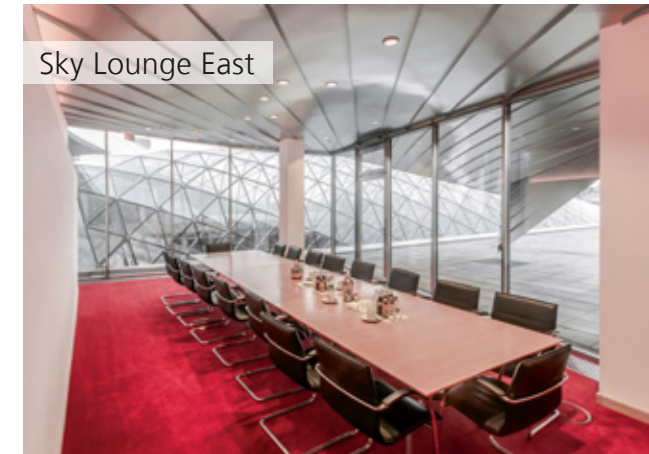

Event type

- » receptions
- » dinner
- » workshops
- » exhibitions
- » presentations
- » conferences
- » film set

Interior & Furnishing

- » open, expansive atmosphere on the 6th floor
- » direct daylight, glass front
- » view of the building's Atrium and the rooftops of Berlin
- » at eye-level with the Quadriga on the Brandenburg Gate and the dome of the Reichstag building
- » fully air-conditioned and ventilated
- » separate cloakroom and toilets

Technology & Equipment

- » coloured interior lighting
- » powered adjustable spotlights
- » WiFi
- » power connections 220 + 380 V
- » technical cooperation with event production experts

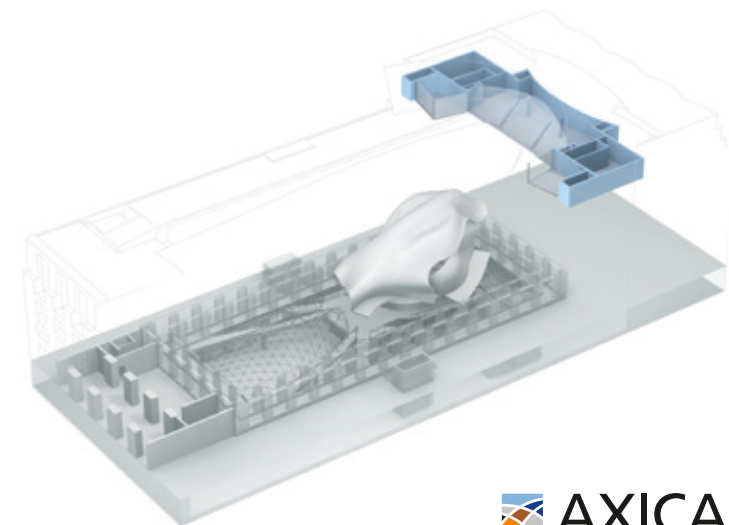



The Sky Lobby With Sky Lounge West & East / Top Floor

M 1:120

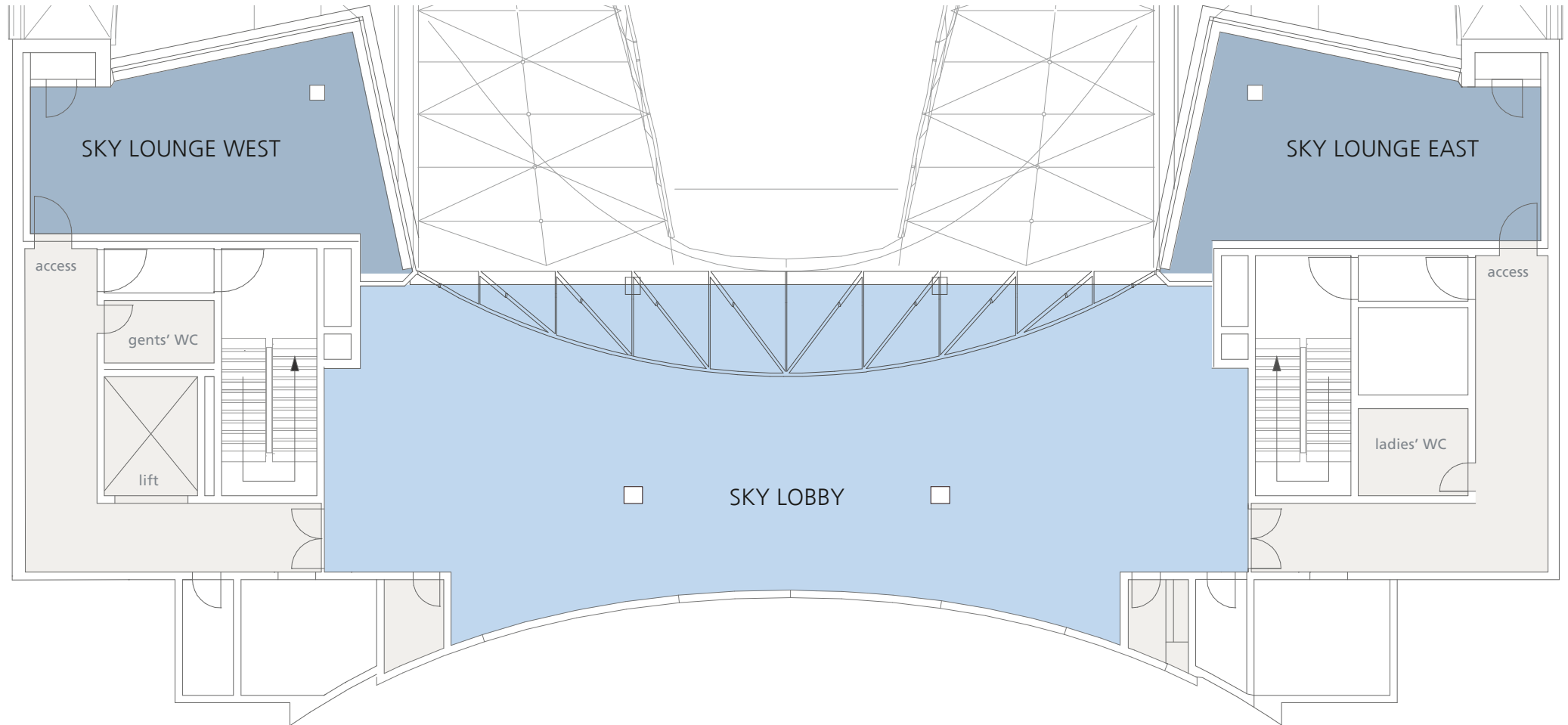
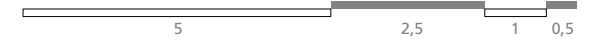

DIMENSIONS SKY LOBBY	
total area	204 m ²
length	24,80 m
width	8,14 - 9,65 m
height	4,35 - 5,59 m

SEATING CAPACITY SKY LOBBY		
classroom		40 delegates
theatre		80 delegates
dinner/buffet		50 delegates
reception		80 delegates

DIMENSIONS SKY LOUNGE	
total area	46 m ²
length	9,00 - 10,00 m
width	4,00 - 5,80 m
height	3,00 m

CAPACITY SKY LOUNGE		
boardroom		18 delegates
theatre		25 delegates
dinner		12 delegates
reception		20 delegates

Evacuation Plan

Ground Floor

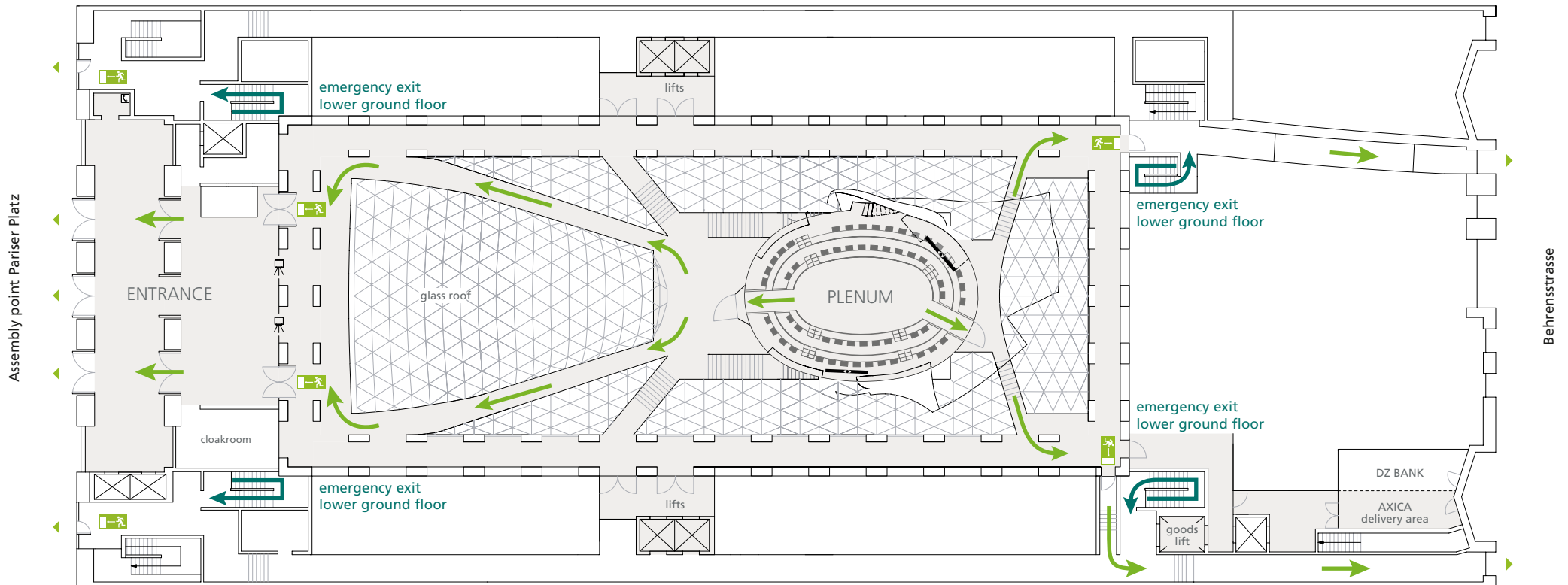

IN CASE OF EMERGENCY

- » Please remain calm.
- » Please evacuate the building via the designated emergency exits.
- » Pay attention to announcements.
- » Do not use lifts.
- » Proceed to the assembly point at Pariser Platz.
- » Await further instructions.



Evacuation Plan

Lower Ground Floor

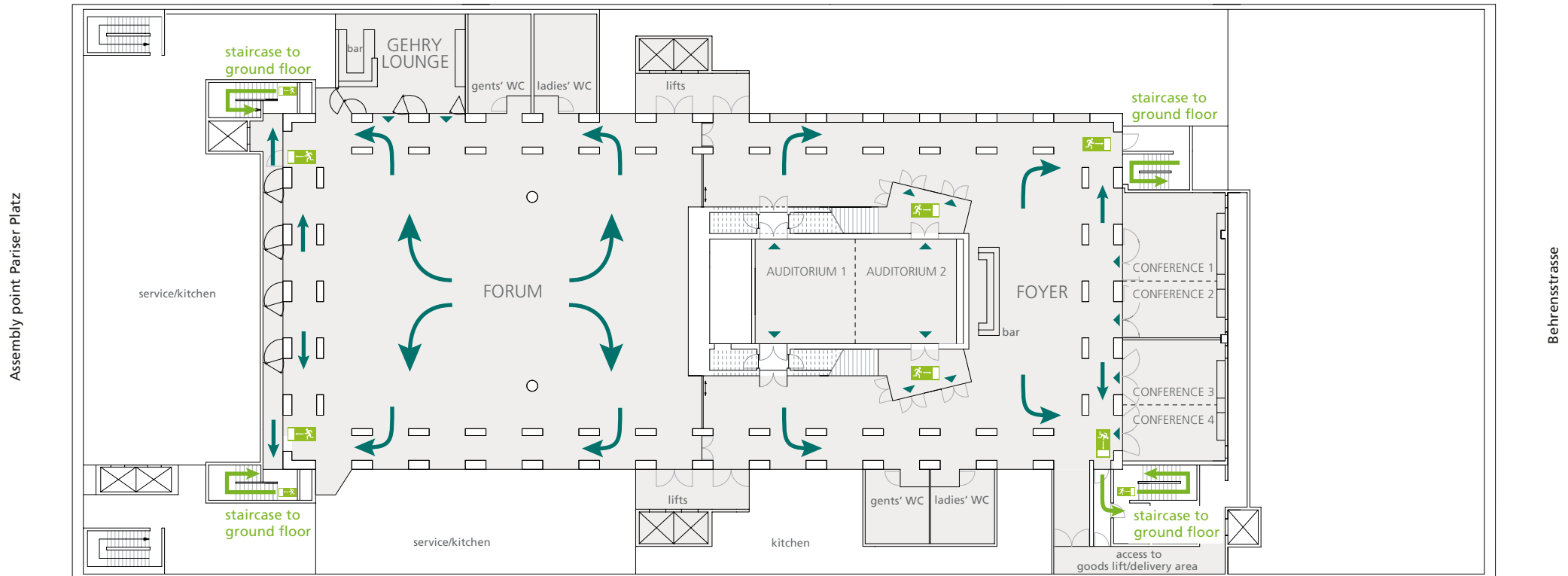

Evacuation Plan

Sky Lobby

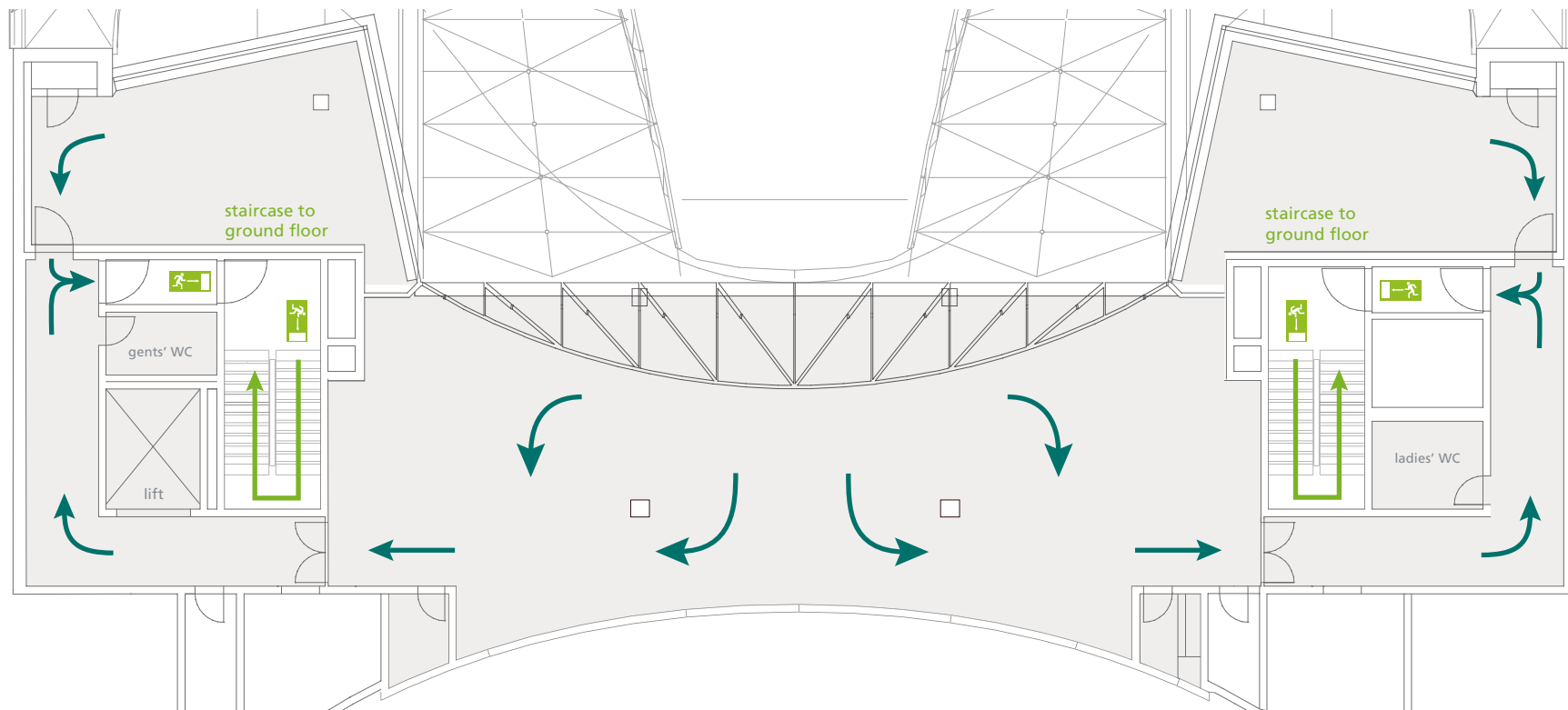

In case of emergency

- » Please remain calm.
- » Please evacuate the building via the designated emergency exits.
- » Pay attention to announcements.
- » Do not use lifts.
- » Proceed to the assembly point at Pariser Platz.
- » Await further instructions.